

Vidosec®

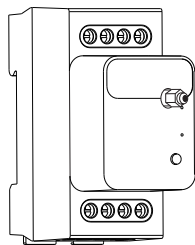

KRC2103-W Phase-cut Dimmer

Instructions

Rail Dual Controller

Introduction

Controller supports WiFi and RF, which can be controlled by Kinetic switch App and wireless kinetic switch. It reserves the input terminals for traditional switches, and can control the light by the original traditional switches. It is mounted in the rail of distribution box. Through the smart speaker, it can achieve ON/OFF by voice control. (Smart speakers like Google Assistant, Amazon Alexa).

Product Parameters

Power supply: AC200V-240V 50/60Hz
Maximum Output Power: LED: 300W
Radio frequency: WiFi 2.4G & RF 433MHz
Operate range: 80m (Outdoors) 25m (Indoors)
(depending on building materials)
Storage Capacity: Each channel can store up to 10 wireless kinetic switch info
Installation Method: the rail of distribution box
RF Receive Sensitivity: -110dBm
Operational Temperature: -20 ~ +55°C
IP Rating: IP20

Note: The effective distance is measured by laboratory. In the actual use, it will vary due to environment changes.

Connection Method

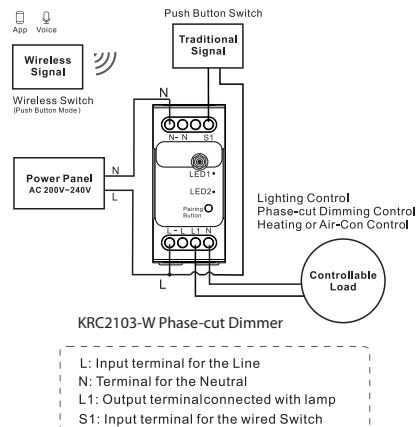

Note: Click Pairing button twice, can switch the output channel.

Installation

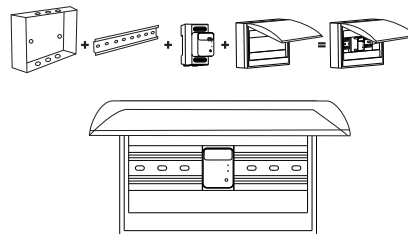

Tuya App Download

The free Tuya App is required to operate your Wi-Fi controller. Ensure your iOS / Android device is connected to the internet using a Wi-Fi network.

Method 1:

1. Open the App store/Google Play on your phone.
2. Search for "Tuya" in the App store or Google Play.
3. Download the Tuya App to your phone.



Method 2:

Or you can download the Tuya app using the QR code below:



Android



iOS

Device Pairing with the APP:

The initial setup must be performed using your 2.4Ghz Wi-Fi network (5Ghz Wi-Fi is not supported). Both the phone and the controller must connect to your network.

1. After downloading the APP follow the prompts to register the account.
2. Turn on power to the controller and the red indicator light enters in fast flashing mode. If the light flashes differently or if you want to reset the controller press the pairing button for 10 seconds - the light will change from slow flashing to fast flashing to still. Release the button.
3. Open the "My Home" page of the Tuya App, and click "+" on the upper right of the page.
4. Click "Light control, select "Wireless Dimming Controller (RF+Wi-Fi)", follow the instruction to operate it.
5. After successfully adding the receiver to the APP you can find the device in the "My Home" list. Lights can be controlled through the App from wherever in the world and smart scenes can be set.



Using Amazon Alexa/Google Home to control your Controller

Note: We would recommend naming the devices in your Tuya App something that is easy for Alexa or Google Home to understand.

In order to integrate the Tuya app with Amazon Alexa/Google Home you need:

- 1) Amazon Alexa APP / Google Home APP
- 2) Amazon Alexa / Google Home account (users need to register their own account)
- 3) Echo, Echo Dot, Tap or other Amazon voice-operated devices.
- 4) Google Home, Google Home Mini or other Google voice-operated devices.

Enable Smart Life skill/action in your Alexa / Google Home APP

Search for "Smart Life" skill and add it to the Alexa APP "Smart Home" skills. For Google Home search for "Smart Life" action and add it to Home Control. Enable the skill/action in your Alexa /Google APP and input the name and password used to register the Kinetic switch APP to link it with Alexa/Google APP. Voice control can be used now to control the Wi fidevice such as: "Alexa/Ok Google, turn on/off [kitchen light]"

Controller Switch Pairing Method

There are two pairing methods for pairing with the receiver and the wireless kinetic switch: Ordinary pairing and Directional pairing.

(1) Ordinary Pairing

App Method

Enter the App page, click "Pairing" -> "Start Pairing". After the App page displays "waiting for pairing", press the corresponding button of the wireless switch that needs to be paired. This will complete the pairing. The App will prompt "Pairing succeeded" after the pairing is completed.

Traditional Hardwired Switch Method

After the receiver is powered on (within 2 minutes), press the hardwired switch for 5 times (within 2 seconds). The light will start flashing, indicating pairing mode. At this time, press the wireless kinetic switch once and the light will stop flashing. The pairing is now completed. If the receiver is powered on for more than 2 minutes it cannot enter the pairing mode through traditional switch.

Physical Wireless Switch Method

1. Press the function button for 3 seconds and the indicator light begins to flash slowly. Release the button to enter the single pairing state.
2. Press the wireless kinetic energy switch and the indicator light of the controller will go out, which means that the pairing is successful.

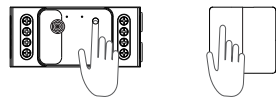

1. Press around 3 seconds, and the indicator light flashes slowly
2. Press the kinetic switch once

(2) Directional Pairing

App Method

Enter the App page, click "Pairing" -> "Start Pairing". After the App page displays "waiting for pairing", press the corresponding button of the wireless switch that needs to be paired 4 times (within 1 seconds). This will complete the pairing. The App will prompt "Pairing succeeded" after the pairing is completed.

Traditional Hardwired Switch Method

After the receiver is powered on (within 2 minutes), press the hardwired switch for 5 times (within 2 seconds). The light will start flashing, indicating pairing mode. At this time, press the wireless kinetic switch 4 times (within 1 seconds) and the light will stop flashing. The pairing is now completed. If the receiver is powered on for more than 2 minutes it cannot enter the pairing mode through traditional switch.

Physical Wireless Switch Method

1. Press the function button for 3 seconds and the indicator light begins to flash slowly. Release the button to enter the single pairing state.
2. Press the wireless kinetic energy switch and the indicator light of the controller will go out, which means that the pairing is successful.

Directional pairing of push button (only supports 2 keys or 6 keys)

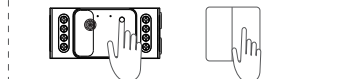

1. Press around 3 seconds, and the indicator light flashes slowly
2. Quick press any key four times (within 0.5 seconds)

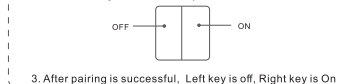

3. After pairing is successful, Left key is off, Right key is On

Bridging Mode

Press the button for 7 seconds. LED1 changes from slow flashing to fast flashing (2 flashes per second), and release the button when it flashes quickly, and the receiver enters the bridging mode. At this time, the light flashes once every 2 seconds. If need to exit the bridging mode, just repeat the above steps.

Clear Pairing Information

App Method

Enter the App page, click "Pairing" -> "Clear Pairing", and select the corresponding channel. After the clearing is completed, App will prompt "Clearing Successful".

Physical button Method

To remove the controller stored pairing information press function button for 12 seconds until the indicator light goes out - the pairing information will be cleared.

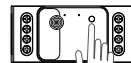

Press the button for 12 seconds and the light will flash fast, then still and then it goes out

Clear Network

App Method

Enter the app device page and select "Remove Device" to clear the device network configuration.

Physical button Mode

Press the button for 10 seconds, the light is flashing to still, and then release the button, LED1 will flash quickly, and the devices will be removed from the App.

Through wired switch (Only support push button)

Within 2 minutes after the controller is powered on, long press anyone wired switch for 15 seconds, and lamp state will be reversed, it means network information of controller is cleared (such as: long press the wired switch 15s, lamp will change from opened to closed, clear network is successful), can add controller through the app at this time. After the controller is powered on more than 2 minutes, the network information of controller cannot be cleared through the wired switch.

Pairing with the APP in AP Mode

The default configuration mode of the receiver is EZ mode (the light flashes quickly, twice per second). When pairing is not successful in EZ mode, you can enter the AP mode. The steps to switch to AP mode are as follows:

1. Press the button for 10 seconds in EZ mode, then release the button after the light is still, and it can switch to "AP mode"
2. In AP mode the light will flash slowly, turning off once every two seconds.
3. To switch from AP mode back to EZ mode, press the button for 10 seconds. The indicator light will flash quickly then still. When the light is still release the button.

Once the AP mode is activated open the "My Home" page of the Kinetic Switch App, and click "+" on the upper right of the page. Click "Light Control", select "Wireless Dual Controller (RF+Wi-Fi)" and enter the Wi-Fi account password.

On the next page tap "EZ Mode" on the upper right corner and select "AP Mode" from the drop down list.

Follow the APP instructions to pair and operate the receiver.

Wired switch control

The controller supports automatic detection of wired switch type (rocker switch or push button): After the controller is powered on, press the wired switch once to set the current wired switch type (for example, if the rocker switch is pressed after the controller is powered on, set the wired switch type to rocker switch). To reset the wired switch type, power off the controller and then power on it. Repeat the preceding steps.