

Videosec®

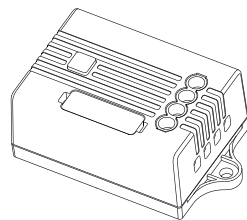

KRC-301 Dimming Controller INSTRUCTIONS

Product description :

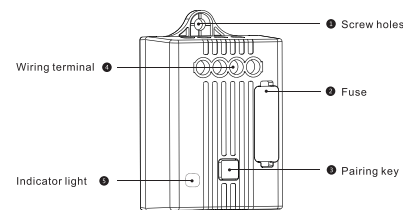

Specification :

Product model: KRC-301

Voltage range: 85-260V, 50/60Hz

Power rating: 1.5A (LED300W)

Temperature range: -20°C~50°C

Effective range: 160m(Outdoor) 30m(Indoor)

Working frequency: 433MHZ

Capacity: Up to 10 switches can be paired

Sensitivity: -110dBm

Dimming method: Triac PWM

Dimension: L70*W44*H29mm

Executive standard: EN61058-1;2002+A2;2008;
GB 14536.1-2008

Wiring :

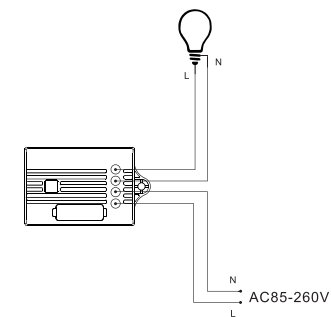

Typical wiring method

Installation:

Method One

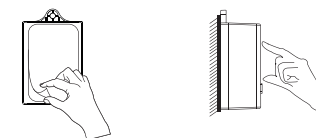

Double sided tape paste

Method Two

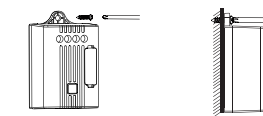

Fix with screws

Dimming Function:

1. KRC-301 controller uses triac components, supporting for PWM dimming mode. To use the dimming function, need to use ordinary tungsten lamp, incandescent lamp, or TRIAC PWM dimming LED lamp.
2. KRC-301 controller defaults off-dimming mode. Need to manually turn on the dimming mode and pair with the push button kinetic energy switch to dimming.
3. Turn on the dimming mode: press and hold the function key for 10 seconds on the controller. Release when the indicator is lit still, and then the dimming mode is on. At this time, the indicator will flash slowly. To turn off the dimming mode, still press and hold for 10 seconds, and release when the light is lit still.
4. Long press the switch to adjust the brightness of the lamp after pairing the switch. The controller will stop the dimming by itself after two cycles if you press so long time.
5. In order to more accurately adjust the brightness, if the interval time between 2 times long presses is less than 1 second, the dimming direction will be reversed.
6. The controller has a brightness memory function under dimming mode. Turn on the light again, and it maintains the last light intensity.

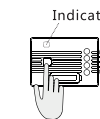

Pairing:

1. KRC-301 controller works with our kinetic energy switch under effective control range.
2. Long press the controller function button for 3 seconds until the indicator slowly flashes.
3. Then press down the wireless kinetic switch. When paired successfully, the indicator stop flashing. One KRC-301 controller switch can pair to 10 switches at maximum.
4. Please try the second step again when fail to pair at the first time.

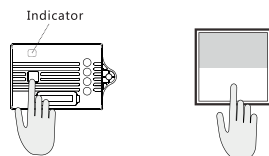

Directional pairing:

Target
To suit the clients' habit of using traditional switches. When one switch pairs with multiple controllers, controllers stay in sync.

Method
Press the switch key double times with fast speed(within 0.5s) during 3rd point of **Pairing**.

The function after directional pairing

Rocker switch

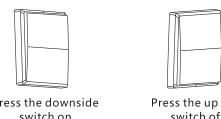

Push button switch

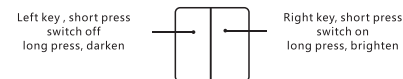

Note: The direction pairing only are suitable for double key push button switch or 6 key push button switch. Left and right two keys for a group

Pairing Combination & Bridging Mode

Combination
By pairing one by one, can freely control in combinations

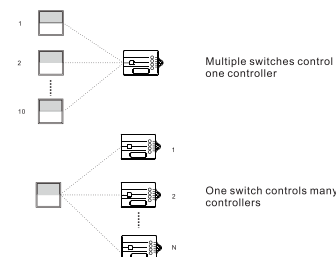

Bridging mode:

1. Under the multi-control mode, you can turn on the bridging mode to enhance the signal.
2. When the mode is on, the receiver will forward the received paired switch signal once.
3. Select one of the nearest controller from the switch. Long press "pairing button" for 7 seconds and release when the LED is flashing fast.
4. Under the bridging mode, the indicator light flashes once every two seconds.

Change the Fuse:

If the controller fuse is fused because of short circuit or overload, please first find the reason. Unclench the fuse cover according to the figure, Replace it with the fuse with the same specifications.

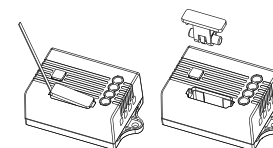

Troubleshooting:

1. No dimming effect or the light flashes when adjusting its brightness, especially when the low brightness.
Troubleshooting method: Please confirm the lamp supports PWM dimming method, You can replace with the ordinary tungsten light to test whether the dimming function of controller is normal.
2. You can normally switch the light on and off but can not long press for dimming.
Troubleshooting: dimming mode is not turned on. Please refer to the dimming section. Turn on dimming mode.
3. A button can only turn off or only on the lights
Troubleshooting method: maybe because press the button too fast in the pairing. Please repair and press the button only once.
4. You cannot turn on the light when press the key.
Troubleshooting: maybe because turn on the light when it is not completely off, causing that the memorized brightness is too low. Please try to long press the key to brighten the light.

Distributor:
Euro Tech Corporation Ltd.
6724 Szeged, Hungary
Ústökös str. 12/b
Web: www.videosec.com